

Instruction Manual

Wireless Smart Gateway

Wi-Fi 2.4GHz & ZigBee 3.0 & BLE & Mesh

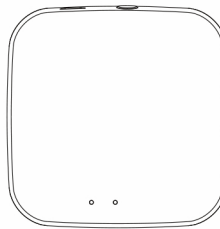

English

MMC2900

Bitte scannen Sie den QR-Code, um das deutsche Handbuch, das Installationsvideo und die Funktionseinführung zu erhalten

Escanee el código QR para obtener el manual en español, el video de instalación y la introducción de la función

Veuillez scanner le code QR pour obtenir le manuel en français, la vidéo d'installation et l'introduction des fonctions

Отсканируйте QR-код, чтобы получить руководство на русском языке, видео по установке и описание функций

Leia o código QR para obter o manual em português, o vídeo de instalação e a introdução das funções

Scansionare il codice QR per aprire il manuale in italiano Manuali, video di installazione e funzionalità Introduzione

Zeskanuj kod QR, aby uzyskać instrukcję obsługi, film instalacyjny i wprowadzenie do funkcji

من فضلكم مسح الرمز الاستجابة السريعة للحصول على دليل المستخدم باللغة العربية وفديو التثبيت ووصف للوظائف



English



请扫描二维码获取说明书手册、安装视频和功能介绍

English

Product Specifications

| | |
|-----------------------|------------------------------------|
| Product name | Wireless Smart Gateway |
| Electrical Parameters | 5V 2A |
| Operating temperature | -10°C-45°C |
| Operating humidity | 5%-90% RH(no condensation) |
| Wireless Protocol | Wi-Fi 2.4GHz & ZigBee & BLE & Mesh |
| Product Size | 65*65*15 mm |
| Product Weight | 60g |

Packing list

- Wireless Smart Gateway
- Instruction manual x 1
- Power cable x 1

Transportation

- 1.The products shall be free from severe vibration, impact, exposure to rain, dumping and other problems during transportation, and shall comply with the provisions of the marks on the packing boxes.
2. This product has no waterproof and dustproof function.

Storage

Products should be put in the warehouse where the temperature is between the range -10°C ~ +45°C, and the relative humidity between the range 5%RH-90%RH(non condensation), indoor environment with no acid, alkali, salt and corrosive, explosive gas, flammable matter, protected from dust, rain and snow.

Safety Information

Do not disassemble, reassemble, modify, or attempt to repair the product by yourself. Such products may cause electric shock, which may cause serious injury or death.

Product Description

The smart gateway is the control center of the ZigBee and Bluetooth device.Users can design and implement smart application scenarios by adding ZigBee and Bluetooth devices

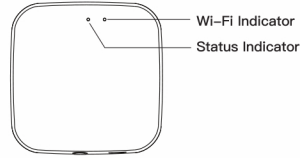

English

English

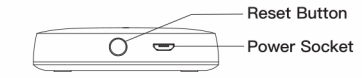

①WiFi Indicator(Red): Configuration Status:

| | |
|-------------------|--|
| Steady On | Successful connection |
| Blinks | Ready for connection |
| Bluetooth/AP mode | Explained as 1500ms ON and 1500ms OFF |
| Steady Off | Successful configuration but the network is disconnected |

②Status Indicator(Blue):

| | |
|------------|--|
| Steady On | Activated |
| Blinks | access learning mode as 500ms ON and 500ms OFF |
| Steady Off | Unactivated |

English

Preparation For Use

1.APP Download Smart Life APP



Please scan the QR code or download Smart Life on App store.

2.Register or Log in



Download "Smart Life" Application Enter the Register/Login interface; tap "Register" to create an account by entering your phone number to get verification code and "Set password". Choose "Log in" if you already have a Smart Life account.

English

English

Add Devices

① Connect power to gateway.Confirm that the LED indicator (red) blinks.(If the indicator is in a different state, press the reset button until red indicator blinks);

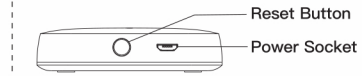

② Make sure Bluetooth switch of the mobile is on, and mobile is connected to the 2.4 Ghz WiFi of home router,at this point, the mobile phone and gateway in the same local area network;



English

English

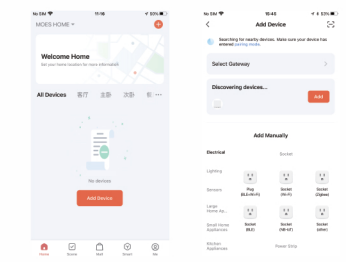

English

English

④ Enter the Wi-Fi password, click "Next", and wait for the connection to complete.Add the device successfully, you can edit the name of the device to enter the device page by click "Next"

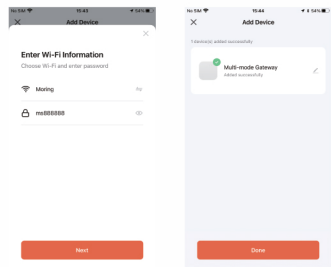

English

⑥ Once the device has been added successfully,you will be able to find the device on the "My Home" page.

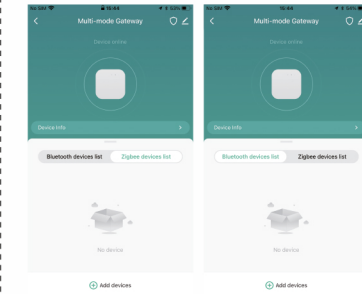

English

English

Electronic Information Products Toxic And hazardous substance Declaration

| Part name | Toxic or harmful substances or elements | | | | |
|-----------|---|------------|------------|----------------------------|------------------------------|
| | Lead Pb | Mercury Hg | Cadmium Cd | Hexavalent chromium Cr(VI) | Polybrominated biphenyl/ PBB |
| PCB board | ○ | ○ | ○ | ○ | ○ |
| Housing | ○ | ○ | ○ | ○ | ○ |
| Cable | ○ | ○ | ○ | ○ | ○ |

O:Indicates that the content of this toxic and hazardous substance in all homogeneous materials of this part is below the maximum limit specified in SJ/T1163-2006 Requirements for Concentration Limits for Certain Hazardous Substances in Electronic Information Products;

X: Indicates that the toxic or hazardous substance contained in at least one of the homogeneous materials of the part exceeds the maximum limit specified in the SJ/T1163-2006 standard

10 The figures in this label indicate that the product has an environmental protection use period of 10 years under conditions of normal use, and some parts may also have an environmentally friendly use period mark. The environmental protection use period is based on the number indicated by the mark.

SERVICE

Thank you for your trust and support to our products, we will provide you with a two-year worry-free after-sales service (freight is not included), please do not alter this warranty service card, to safeguard your legitimate rights and interests. If you need service or have any questions, please consult the distributor or contact us.Product quality problems occur within 24 months from the date of receipt, please prepare the product and the packaging, applying for after-sales maintenance in the site or store where you purchase; If the product is damaged due to personal reasons, a certain amount of maintenance fee shall be charged for repair.

We have the right to refuse to provide warranty service if:

1. Products with damaged appearance, missing LOGO or beyond the service term
2. Products that are disassembled, injured, privately repaired, modified or have missing parts
3. The circuit is burned or the data cable or power interface is damaged
4. Products damaged by foreign matter intrusion (including but not limited to various forms of fluid, sand, dust, soot, etc.)

English

English

Troubleshooting

Q1. Can gateway/router control Zigbee devices on upper and lower floors or through the wall?

A.It is possible to control the devices through the wall, but the specific distance depends on the thickness and the material of the wall. It is hard to control the devices on upper and lower floors and you can have a ZigBee repeater to effectively expand the range of ZigBee communication network.

Q2. What should I do if the signal coverage of gateway/router is poor?

A.This is related to the location of the gateway/router and its distance from the sub-devices;There should be more than 2 gateways/routers needed for large flat floor, villa and other environments or with the ZigBee repeater required.

Q3.Can sub-devices on different gateways be linked?

A.Hello, yes, not only the cloud link, but also the local linkage of multiple gateways in the same LAN supported,and the sub-device linkage can still be performed efficiently when the network is disconnected or the cloud problem occurs,(the premise is that there is at least one gateway featured with strong performance, such as a wired ZigBee gateway).

English

Q4.What if the sub-devices fails to be added to the gateway?

A>Hello, please make sure that you have reset the sub-device for configuration state. It may also be due to insufficient wireless signal strength. Ensure that there is no metal wall barrier or interference from high-power electrical appliances between the gateway device and its sub-devices (it is recommended that the distance between the gateway device and its sub-devices shall less than 5 meters with no wall).

RECYCLING INFORMATION

All products marked with the symbol for separate collection of waste electrical and electronic equipment (WEEE Directive 2012/19 / EU) must be disposed of separately from unsorted municipal waste. To protect your health and the environment, this equipment must be disposed of at designated collection points for electrical and electronic equipment designated by the government or local authorities. Correct disposal and recycling will help prevent potential negative consequences for the environment and human health. To find out where these collection points are and how they work, contact the installer or your local authority.



English

English

WARRANTY CARD

Product Information

Product Name _____

Product Type _____

Purchase date _____

Warranty Period _____

Dealer Information _____

Customer's Name _____

Customer Phone _____

Customer Address _____

Maintenance Records

| Failure date | Cause Of Issue | Fault Content | Principal |
|--------------|----------------|---------------|-----------|
| | | | |
| | | | |
| | | | |

DA13

English

English