

Instruction Manual Smart Curtain Switch Module ZigBee MMC1981

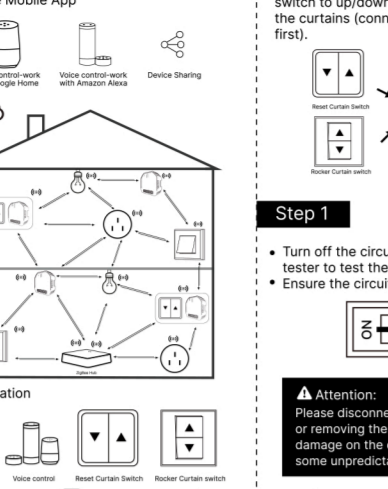

Global international operation Whenever & Wherever you are, All-in-one Mobile App

Note: Press the traditional curtain switch once after switch to up/down (any button on the switch) to stop the curtains

Step 1 Turn off the circuit breaker and use the electrical tester to test the power

Step 2 Remove the old switch

Step 3 Remove the switch and pull it away from the wall. Identify Line/Load Wire

PRODUCT DESCRIPTION ZIGBEE smart curtain switch on-off is a smart home device, which combines ZIGBEE wireless communication technology and the function of curtain switch on-off to realize the intelligent control of curtains.

TECHNISCHE SPEZIFIKATIONEN Produktart ZigBee-RF-Vorhangmodul, Stromspannung 90-250V AC 50/60Hz, Max. Leistung 2A

Method 1 Scannen Sie den QR-Code, um die Netzwerkanleitung zu konfigurieren. Stellen Sie sicher, dass Ihr MOES erfolgreich ein ZigBee-Gateway angeschlossen wurde.

Method 2 Stellen Sie sicher, dass Ihr Telefon erfolgreich mit einem ZigBee-Gateway verbunden ist.

3 Geben Sie das Gateway ein. Bitte folgen Sie das untenstehende Bild, um als „Subdevice hinzuzufügen“ abzuschießen.

EMC Standard (EMC) EN 300 328 V2.1.1 (2016-11), EN 301489-1 V2.1.1 (2017-02), EN 301489-17 V3.11 (2017-02), EN 62311: 2008, EN 55015:2013

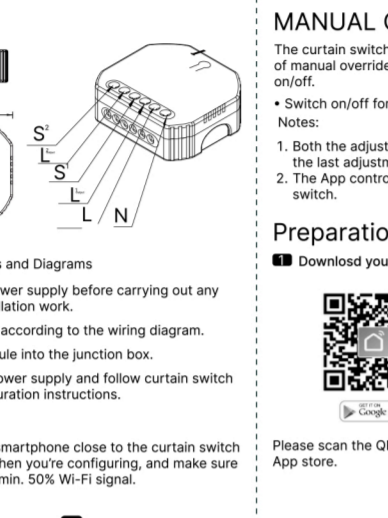
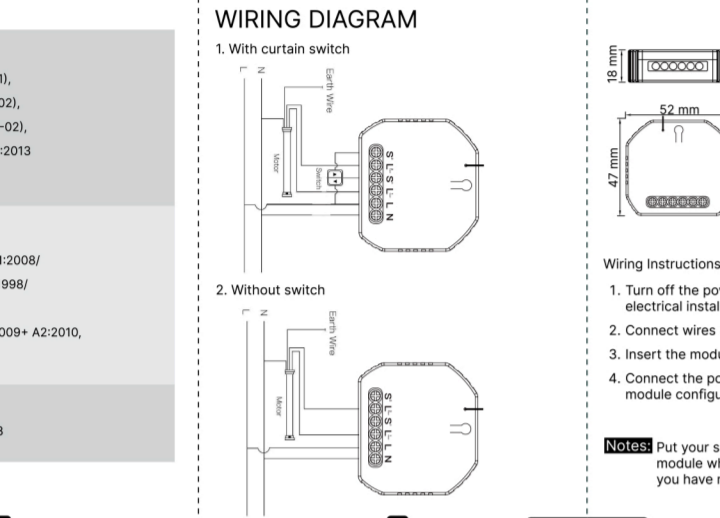

MANUAL OVERRIDE The curtain switch module terminal reserves the access of manual override function for the end-user to switch on/off.

Preparation For Use Download your APP

Registration or Log in

Method 1 Scan the QR code to configure the network guide. Make sure your phone has successfully connected to a ZigBee gateway.

Method 2 Make sure your phone has successfully connected to a ZigBee Gateway.

Manual de Instrucciones (Español) INSTALACIÓN Advertencias: La instalación debe ser realizada por un electricista calificado de acuerdo con las regulaciones locales.

Registro o Iniciar Sesión

Method 1 Escanee el código QR para configurar la guía de red. Asegúrate de que tu dispositivo MOES se haya conectado a una puerta de enlace ZigBee.

Method 2 Asegúrate de que tu teléfono se haya conectado correctamente a una Puerta de Enlace ZigBee.

3 Ingrese a la puerta de enlace. Por favor, siga la imagen de abajo para completar "Agregar un dispositivo secundario"

2 Reset/Press the reset button for more than 7 seconds until the beep sounds continuously rapidly as Di-Di-Di... for entering into ZigBee pairing mode.

3 Enter the gateway. Please follow the picture below to finish as "Add subdevice+LED already blink, and the connecting will take about 10-120 seconds to complete depending on your network condition.

4 Add the device successfully, you can edit the name of the device to enter the device page by click "Done".

5 Click "Done" to enter the device page to enjoy your MOES with home automation.

FAQ Q1: Does this work with Google Home? A: Yes it does. And it's also compatible with Alexa.

Enter Smart Life Skill in Alexa APP

3. In the upper left corner of Home page, press the button to show APP Menu. Then select in the menu.

Manuel d'instructions (Français) INSTALLATION Avertissements: L'installation doit être effectuée par un électricien qualifié conformément aux réglementations locales.

Inscription ou connexion

Method 1 Scannez le code QR pour configurer la guide réseau. Assurez-vous que votre MOES est bien connecté à une passerelle ZigBee.

Method 2 Assurez-vous que votre téléphone a réussi à se connecter à une passerelle ZigBee.

3 Entrez la passerelle. Veuillez suivre l'image ci-dessous pour terminer "Ajouter un sous-dispositif"

4. Type in "Smart Life" in the search and press the search button next to it.

6. Once your account has been successfully linked, scroll to discover devices. After a 10-second searching, Alexa will show all the available devices.

7. In the Smart Home page, you can group your devices into different categories. Your Smart Life APP has now been paired with Alexa. Now you can control your Smart Device through Alexa.

2. How to connect Smart Device to Amazon Alexa.

3. Enter "smart life" in the search box and then search for it. Enable smart life skills, and then log in to your mees account to complete the account setup.

RF Link Method

SERVICE Thank you for your trust and support to our products, we will provide you with a two-year worry-free after-sales service (freight is not included), please do not alter this warranty service card, to safeguard your legitimate rights and interests.

Manuale di istruzioni (Italiano) INSTALLAZIONE Avvertenze: L'installazione deve essere eseguita da un elettricista qualificato in conformità con le normative locali.

Registrazione o Accedi

Method 1 Scansiona il codice QR per configurare la guida di rete. Assicurati che il tuo MOES sia stato correttamente connesso a un gateway ZigBee.

Method 2 Assicurati che il tuo telefono sia correttamente connesso alla Gateway ZigBee.

3 Inserire la passerella. Seguire l'immagine sottostante per completare così: "Aggiungi sottodispositivo" -> LED già lampeggiante, e la connessione impiegherà da 10 a 120 secondi a completarsi a seconda della condizione della rete.

RECYCLING INFORMATION All products marked with the symbol for separate collection of waste electrical and electronic equipment (WEEE Directive 2012/19 / EU) must be disposed of separately from unsorted municipal waste.

WARRANTY CARD Product Information Product Name, Product Type, Purchase Date, Warranty Period, Dealer Information, Customer's Name, Customer Phone, Customer Address.

Maintenance Records table with columns: Failure date, Cause of Issue, Fault Content, Principal

2. How to connect Smart Device to Amazon Alexa. (Continued)

3. Enter "smart life" in the search box and then search for it. (Continued)

RF Link Method (Continued)

SERVICE (Continued)

Manuale de instruções (Português) INSTALAÇÃO Avisos: A instalação deve ser realizada por um electricista qualificado de acordo com as regulamentações locais.

Registrar ou entrar

Method 1 Guia de rede para a configuração do código QR. Certifique-se de que o seu MOES está ligado à ponte ZigBee.

Method 2 Verifique se seu telefone está conectado com sucesso ao Zigbee gateway.

3 Entra na passerella. Por favor, siga a imagem abaixo para completar adicionar um subdispositivo -> o LED piscou a conexão levará cerca de 10 a 120 segundos para concluir, dependendo das condições da sua rede.

O dispositivo foi adicionado com sucesso. Você pode alterar o nome do dispositivo. Accese a página do dispositivo clicando em "Renomear".